

- ▶ Event & Exhibition
- ▶ Tent Rental Companies

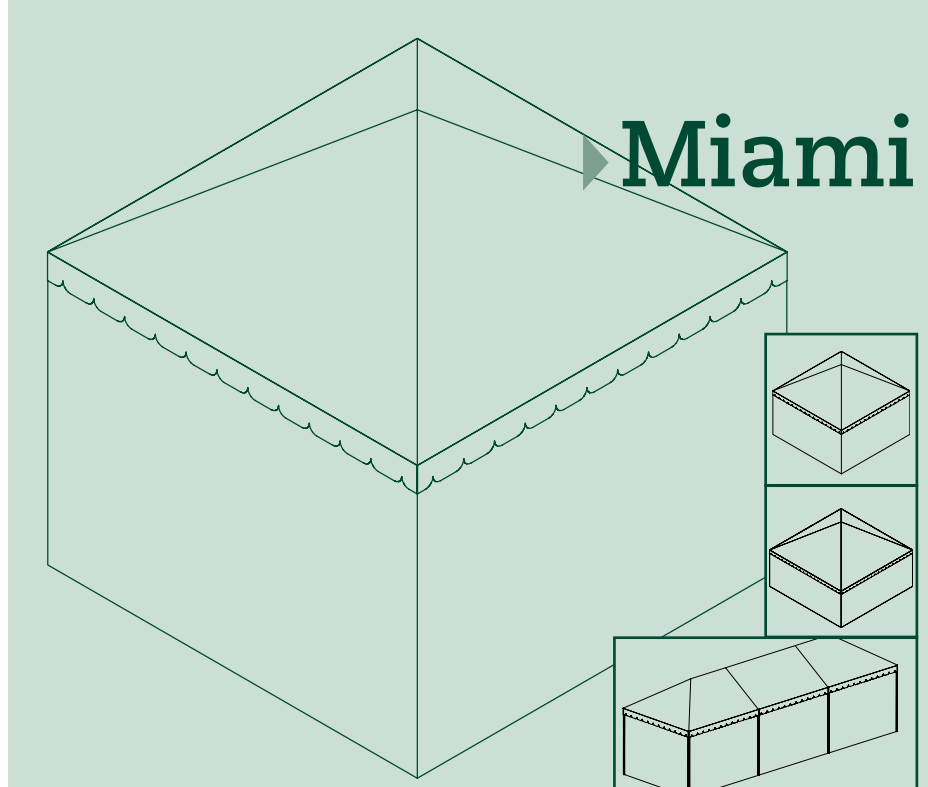

Dimensions	3x3 m	4x4 m	5x5 m	Walkway 3 m		
Side height	2,2 m					
Surface	9 m <sup>2</sup>	16 m <sup>2</sup>	25 m <sup>2</sup>	Every 9m <sup>2</sup> expandable		



The Miami, with a simple design and flexible use, in short it is always an attractive addition!  
 From entry tent to attractive passageway;  
 from covering for your garden party to a stylish stand. The Miami is rightly a valued classic.



In addition you can finish the hall as you choose amongst others with **gothic windows, guttering**

Accessories



## Cross section drawing

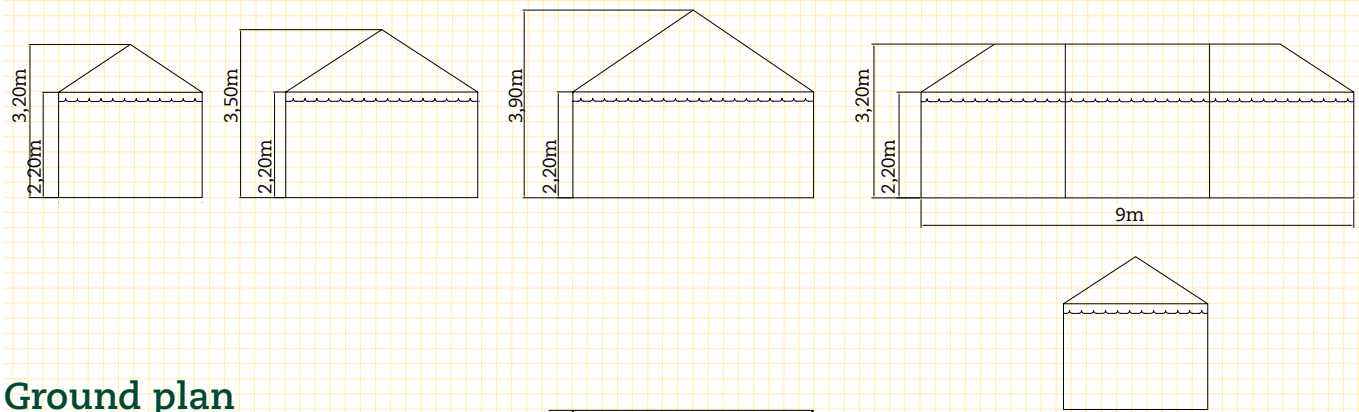

## Ground plan

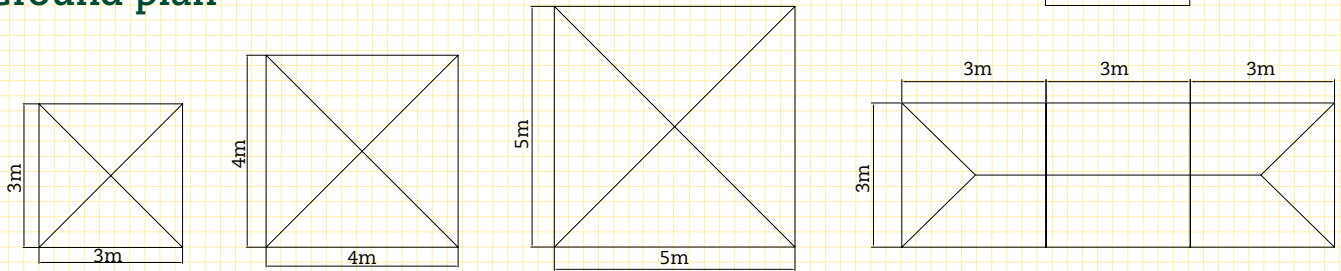

## Construction

A self-supporting aluminium construction with galvanised steel corner and ridge connections. The standard anchoring is realised with stakes. The stability is ensured using wind bracing.

Technical specifications				
Standard width	3 m	4 m	5 m	Walkway 3 m
Standard length	3 m	4 m	5 m	Unlimited
Side height	2,20 m			
Ridge height	3,20 m	3,50 m	3,90 m	3,20 m

## Roof fabric

The roof fabric is made from PVC coated polyester fabric (white translucent, white non-translucent or colour). The roof fabric is stretched using ratchets. Flame retardant according to the French standard M2, German standard DIN 4102 B1 and British Standard BS 5438. The fabric is UV-stabilised and treated against deterioration due to rot and mildew.

## Sidewalls

The sidewall fabrics are made from PVC coated polyester fabric (white translucent, white non-translucent or colour). Flame retardant according to the French standard M2, German standard DIN 4102 B1 and British Standard BS 5438. The fabric is UV-stabilised and treated against deterioration due to rot and mildew. One sidewall is made from two sections connected with rings and loops. The sidewall is attached to the connection bars at the bottom with straps. This prevents the fabric from flapping in strong winds.

